

Hisense

Quick Start Guide

5.1.2CH Soundbar with wireless subwoofer & Dolby Atmos

Model: HS512

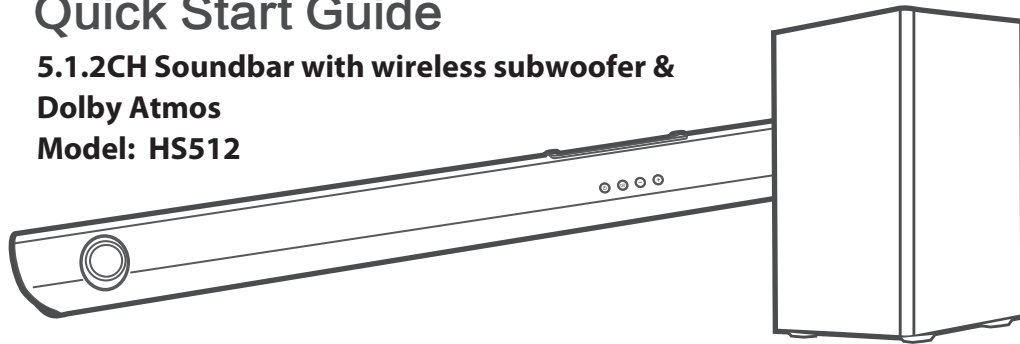

DOLBY ATMOS® dts X® HDMI™ Bluetooth® 4K HDR

What's in the Box

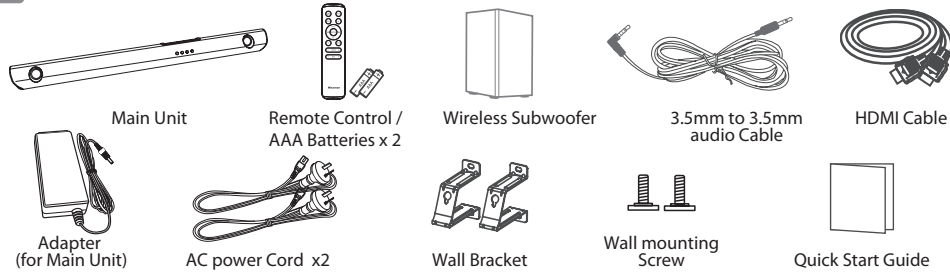

1 Remote control

- ① **ON/OFF** Switch the unit between ON and STANDBY mode.
- ② **MUTE** Mute or resume the sound.
- ③ **SOURCE** Select the play function.
- ④ **BT** Select the Bluetooth mode.
- ⑤ **VOL+/VOL-** Increase/decrease the volume level.
- ⑥ **⏮/⏭** Skip to previous/next track in Bluetooth/USB mode.
- ⑦ **▶/⏸/⏪/⏩** Play/pause/resume playback in Bluetooth/USB mode.
Press and hold to activate the pairing function in Bluetooth mode or disconnect the existing paired Bluetooth device.
- ⑧ **EQ** Select a preset sound effect.
- ⑨ **SURROUND** Adjust the surround ON/OFF.
- ⑩ **DIMMER+/-** Adjust display brightness.
- ⑪ **BASS+/-** Adjust bass level.

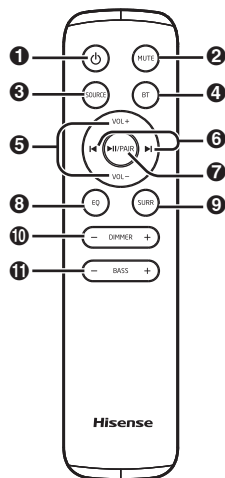

Replace the Remote Control Battery

- 1 Press and slide the back cover to open the battery compartment of the remote control.
- 2 Insert two AAA size batteries (included). Make sure the (+) and (-) ends of the batteries match the (+) and (-) ends indicated in the battery compartment.
- 3 Close the battery compartment cover.

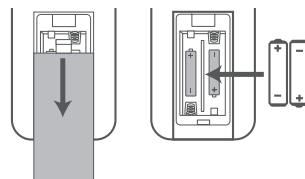

2 Identifying the Parts

Main Unit

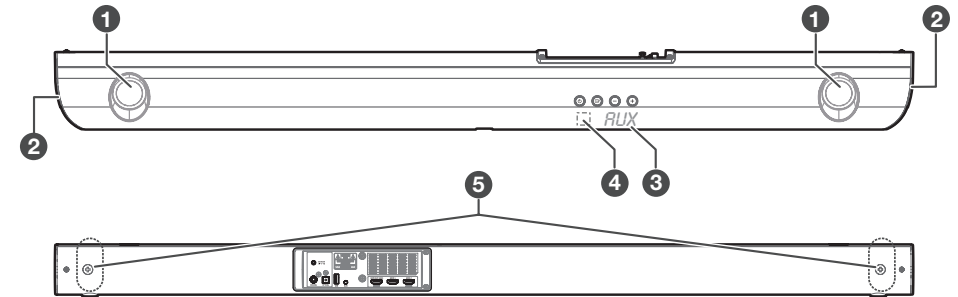

- 1 **Overhead Sound**
- 2 **Surround Speakers**
- 3 **Display Window**
Show the current status.
- 4 **Remote Control Sensor**
Receive signal from the remote control.
- 5 **Screws**
Remove the screws then install the wall mounting screws into the back of the unit.

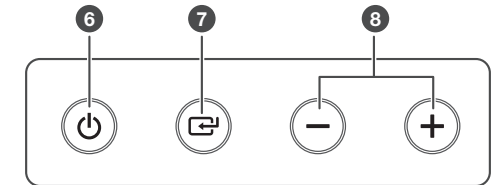

- 6 **ON/OFF** button
Switch the unit between ON and Standby mode.
- 7 **SOURCE** button
Select the play function.
- 8 **VOL+/VOL-** buttons
Increase/decrease the volume level.
- 9 **DC IN 23V** Socket
Connect to adapter.
- 10 **COAXIAL** Socket
- 11 **OPTICAL** Socket
- 12 **USB** Socket
Insert the USB device to play music.
- 13 **AUX** Socket
Connect to an external audio device.
- 14 **HDMI OUT (ARC)** Socket
Connect to a TV via HDMI cable.
- 15 **HDMI IN 1** Socket
- 16 **HDMI IN 2** Socket

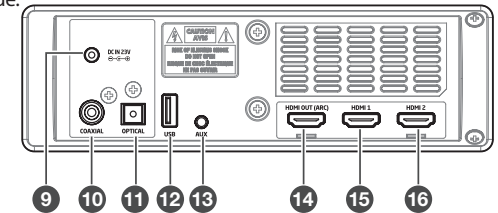

Wireless Subwoofer

- 1 **AC~ Socket**
Connect to power.
- 2 **PAIR** button
Press activate the pairing function between the main unit and the subwoofer.
- 3 **PAIR Indicator**
Light up solidly when the pairing succeed.

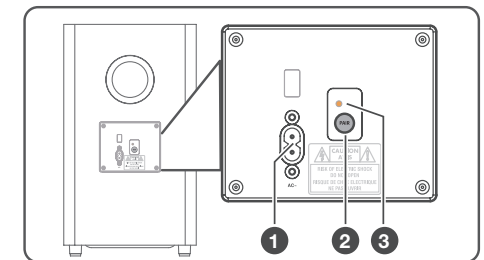

3

Connections

- **Dolby Atmos**
- **DTS: X**

Dolby Atmos® / DTS: X is available only in HDMI mode.

1. To use Dolby Atmos® / DTS: X in HDMI 1 and HDMI 2 mode, Your TV had to support Dolby Atmos® / DTS: X or HDMI audio passthrough.
2. Make sure that "No Encoding" is selected for bitstream in the audio output of the connected external device (e.g. Blu-ray DVD player, TV etc.).
3. While entering Dolby Atmos / DTS: X / Dolby Digital / PCM format, the soundbar will show DOLBY ATMOS / DTS: X / DOLBY AUDIO / PCM AUDIO.
4. While the soundbar is using Dolby Atmos / DTS: X audio, you can only adjust the bass level of the subwoofer. All other EQ effects will not be available.

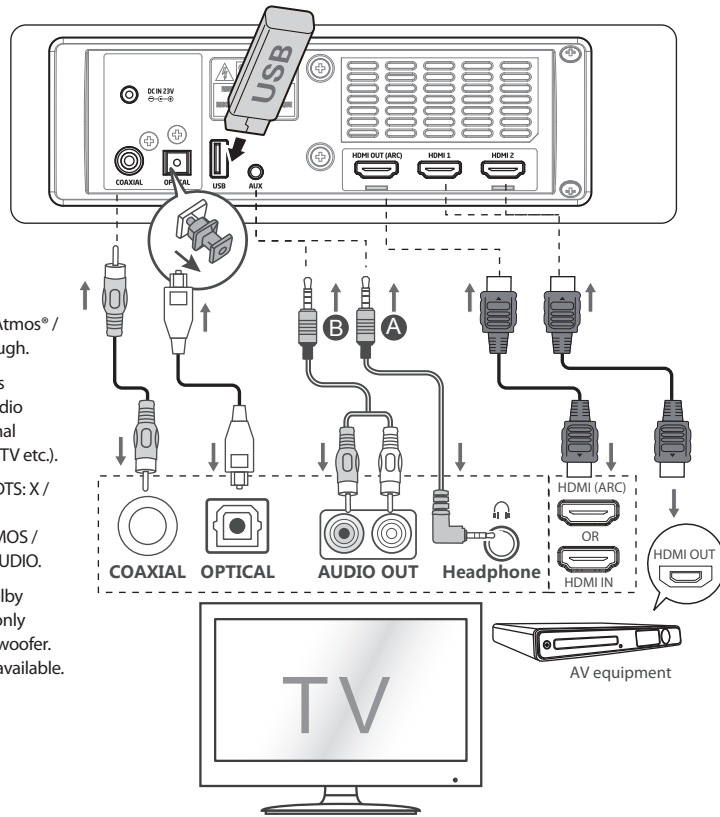

- Before connecting the AC power cord, ensure you have completed all other connections.

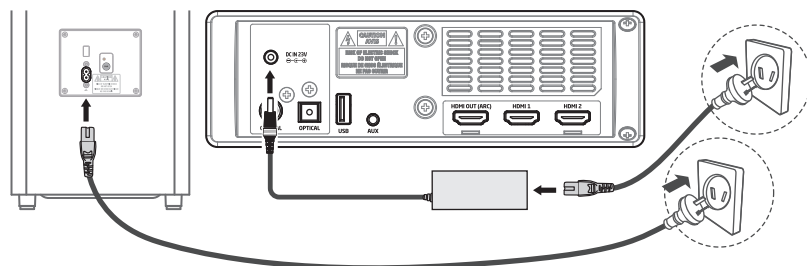

Pairing the Wireless Subwoofer with the Main Unit

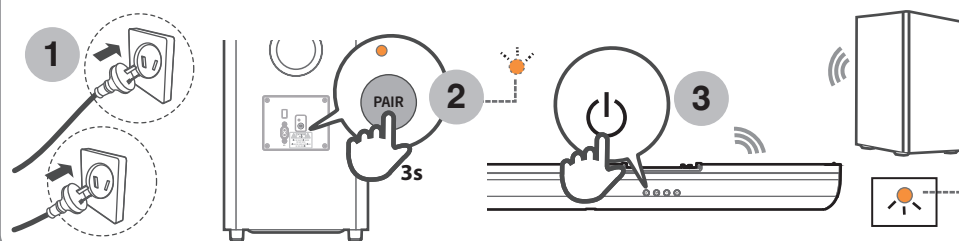

4

Basic Operation

Standby/ON

When you first connect the main unit to the mains socket, the main unit will be in Standby mode.

- Press the **⏻** button on the unit or on the remote control to switch the unit ON.
- Press the **⏻** button again to switch the unit back to STANDBY mode.
- Disconnect the mains plug from the mains socket if you want to switch the unit OFF completely.
- If a TV or an external device is connected, the unit will switch on automatically when the TV or the external device is switched on.
- When there is no input signal from the unit in over 15 minutes, then it will automatically switch to Standby mode.

Select Modes

Press the **⏮** (SOURCE) button repeatedly on the unit or the SOURCE, BT buttons on the remote control to select the AUX, OPTICAL, COAXIAL, HDMI 1, HDMI 2, HDMI ARC, USB and BT (Bluetooth) mode. The selected mode will show on the display.

Adjust the Bass Level

Press the **BASS +/-** buttons on the remote control to adjust bass level. (bass +5 ~ bass -9).

Turn the Surround Sound ON/OFF

Press the **SURROUND** button on the remote control to turn on the surround sound. Press this button again to turn off the surround sound.

Adjust the Volume

Press the **VOL+ / VOL-** buttons on the unit or on the remote control to adjust the volume. If you wish to turn the sound off, press the **MUTE** button on the remote control. Press the **MUTE** button again or press the **VOL+ / VOL-** buttons on the unit or on the remote control to resume normal listening.

Adjust the Brightness

Press the **DIMMER +/-** button on the remote control to select brightness level.

Select a Preset Sound Effect

While playing, press the **EQ** button on the remote control to select desired preset equalizers: MOVIE, MUSIC, NEWS, SPORT.

5

Wall Mounting

